



Montgomery Historical Society  
P. O. Box 47 Montgomery, Vermont 05470  
[www.montgomeryvt.us/mhs.htm](http://www.montgomeryvt.us/mhs.htm)  
[pratthall@gmail.com](mailto:pratthall@gmail.com)

## Who was the original owner of your property?

If you've read the 1780 Montgomery Town Charter you will have seen a list of individuals to whom land was granted, the original owners. They included Governor Thomas Chittenden and State Surveyor Ira Allen (no conflict of interest there!). There is no evidence that any of the grantees ever visited or lived in Montgomery. Rather the land was sold, (or sometime awarded to Revolutionary War veterans for service as was the case for Joshua Clapp), and then subdivided, or combined, and over time evolved into the present day boundaries approximated by the Tax Map.

Montgomery was originally a square containing 23,040 acres divided into 12 lots wide by 12 lots long. Each of the lots were approximately  $\frac{1}{2}$  mile square and totaled 160 acres. Some of these were further subdivided into 4, 40 acre lots. Each grantee was awarded 2 of the 160 acres lots and 1 of the 40 acre lots, not adjoining, for a total of 360 acres. Other lots were set aside for the benefit of the town, county, and state schools/university and the first minister/ministry.

The lotting map was put together and lots were granted without regard to topography. For example a lot to benefit the State university was in Hazen's Notch, and a lot to benefit the ministry was in the Deep Gibou.

The map that follows is a copy of an 1898 hand drawn copy of the original lotting map, with Montgomery's contemporary road system added. Lots are labeled with the grantee's name and there is a legend with an alphabetical list of the grantees with coordinates on the matrix to help you find each individual's lots. If you know the approximate location of your land in relation to the roads shown, you will be able to tell who originally owned your property in 1789 when the legislature approved the charter. This map is only an approximation.

In the future we hope to add an appropriately scaled copy of the current tax map boundaries which will make this determination even easier.

None of the lots of Montgomery's southern pan handle, lands formerly belonging to Lowell and Avery's Gore, were included in the original charter grants

Richford.

Name of Original Proprietor	Acres	Value
1. Adams, Andrew	4 3 7 24	
2. Allen, Ira	7 2 12 23	
3. Alwater Russell	6 1 1 10 2	
4. Alwater Reuben	4 5 7 14 4	
5. Bristol, Elisha	4 3 12 6 6	
6. Burlew, Aaron	3 5 6 9 40	
7. Burlew, James	1 5 3 3 20	
8. Bradley, Stephen R.	5 3 5 7 16	
9. Bradley, Thaddeus	17 3 3 11 4	
10. Brewster, Ebenezer	11 2 3 7 61	
11. Burr, Elijah	1 6 7 6 31	
12. Burr, William	10 2 9 9 24	
13. Champion, Judah	7 1 10 1 22	
14. Chattenden, Thomas	10 4 1 7 27	
15. Clark, Hannah	11 4 6 7 34	
16. Cole, John	7 4 10 6 30	
17. Edwards, Pierpont	2 2 1 8 10	
18. Edwards, Jonathan	9 3 7 6 5	
19. Farts, Noble	10 5 7 10 19	
20. Farrand, Daniel	7 2 8 12 25	
21. Fassett, John, Jr.	4 4 7 8 25	
22. Fay, Jonas	5 1 8 8 27	
23. Fish, Sarah	4 2 8 6 2	
24. Fish, Ruth	12 1 9 6 25	
25. Fish, Solomon	2 1 6 10 39	
26. Fish, Winzer	4 5 4 10 2	
27. Fox, John	8 4 4 9 23	
28. Fox, William	2 4 2 2 9 27	
29. Fox, John A.	5 5 10 8 46	
30. Gault, Josiah	1 3 4 11 7	
31. Gault, William	6 3 4 8 56	
32. Gidd, Ezekiah	12 4 9 11 28	
33. Gidman, John	2 6 6 11 26	
34. Gidman, Nathaniel	12 2 9 10 32	
35. Givard, Matthew	2 5 10 10 33	
36. Hart, Nathan	3 4 8 10 39	
37. Hill, Elizabeth	4 1 11 7 42	
38. Kibbutz, John	3 3 5 11 22	
39. King, Thomas	9 1 6 8 37	
40. Lee, Seth	6 2 1 10 60	
41. Munson, Enos	10 1 7 9 44	
42. Newell, Abel	1 2 3 10 44	
43. Olcott, Buckley	5 2 3 11 41	
44. Perry, David	6 6 1 9 11	
45. Pettibone, Giles	11 3 10 12 58	
46. Robbins, Simon R.	1 4 7 9 20	
47. Samp, Comfort	4 3 8 9 63	
48. Selman, Moses	5 4 2 8 57	
49. Shelton, Seth	3 2 2 7 44	
50. Smith, Asa	10 3 1 12 67	
51. Smith, Joshua	11 5 5 12 21	
52. Smith, Seth	6 4 9 8 51	
53. Starr, Peter	4 6 2 10 8	
54. Stiles, Ezra J.	3 6 1 11 8	
55. Stiles, Isaac	10 5 5 10 9	
56. Strong, Joseph	5 3 5 7 7	
57. Tanton, John	5 2 10 7 27	
58. Talbot, Oliver	1 1 5 7 1	
59. Wolcott, Alexander	8 2 10 7 3	
60. Minister, F. & M.	6 5 3 9 24	
61. Minister, U. & J.	11 1 1 9 35	
62. Olcott, G. & M.	5 6 4 7 47	
63. Deane, John	3 1 11 6 57	
64. Deane, John	2 3 11 11 58	
65. University	2 3 11 11 58	

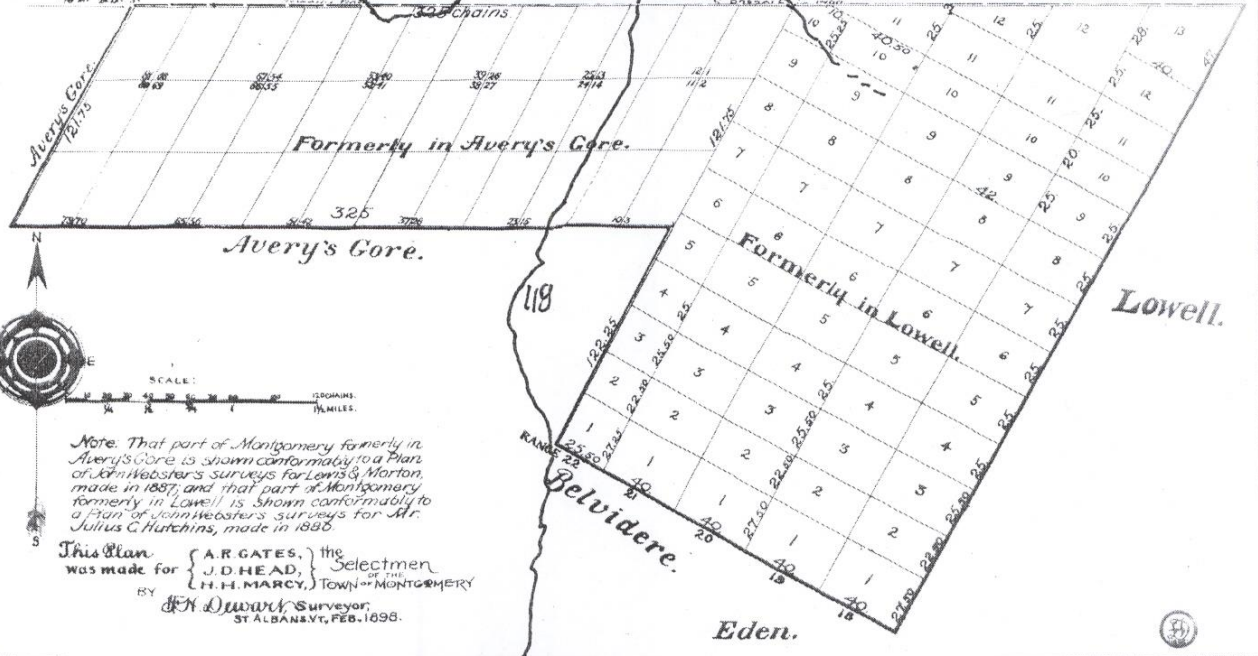
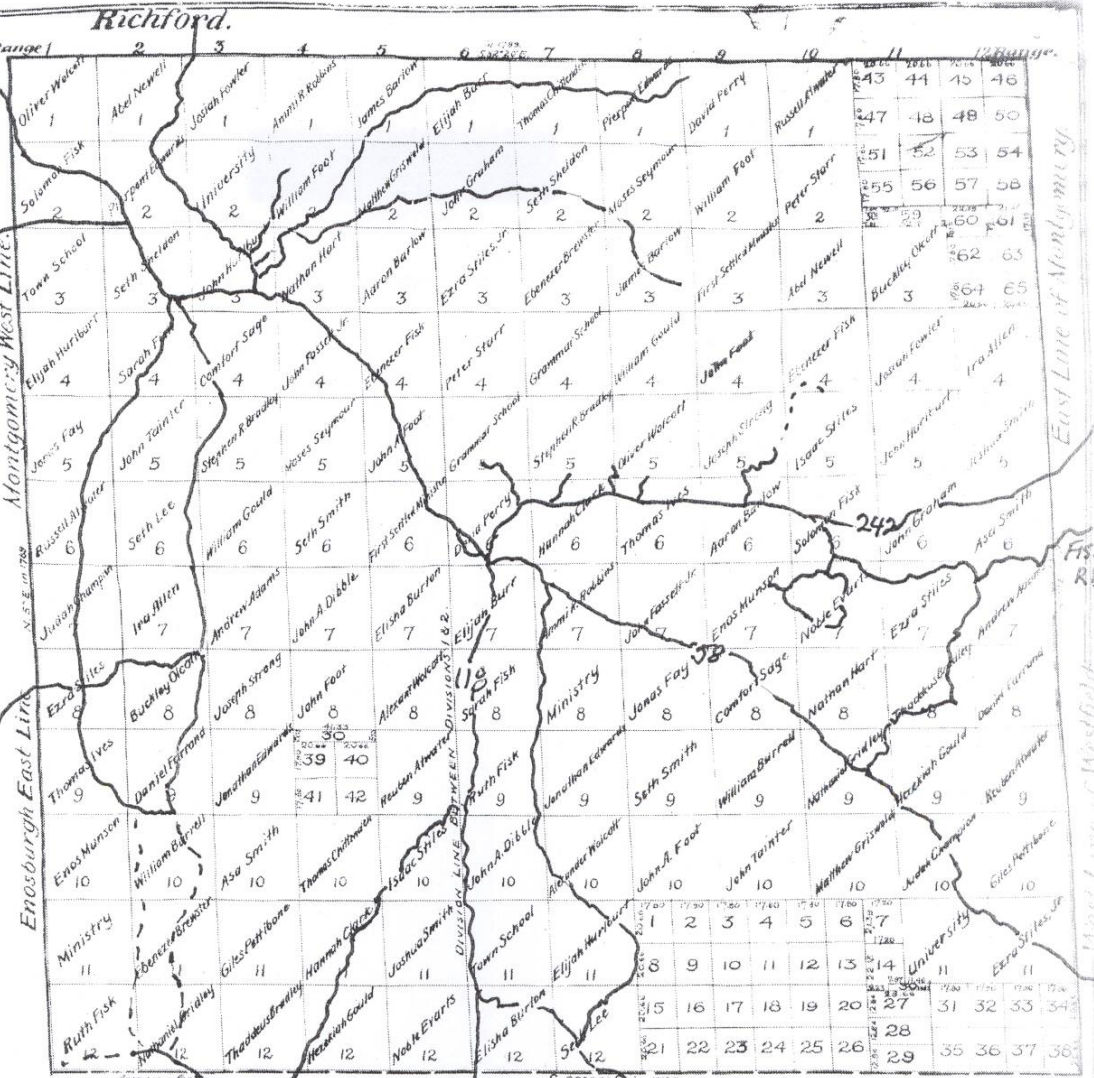

Note. That part of Montgomery formerly in Avery's Gore is shown conformably to a Plan of John Webster's surveys for Lewis & Morton, made in 1887, and that part of Montgomery formerly in Lowell is shown conformably to a Plan of John Webster's surveys for Mr. Julius C. Hutchins, made in 1886.

This Plan was made for { A. R. GATES, } the Selectmen  
 { J. D. HEAD, }  
 { H. H. MARCY, } TOWN OF MONTGOMERY  
 BY J. N. Dewar, Surveyor,  
 ST. ALBANS, VT., FEB. 1898.

MASTER